

EH3 - Electronic humidistat and controller

The EH3

can regulate and monitor:

- Relative humidity % RH
- Absolute humidity g/kg
- Dew-point °Cdp
- Temperature °C / K / °F



Two closing contacts:

Possible to choose source from one of the four parameters above to each relay. Used for controlling one dehumidifier in two steps or to control two separate dehumidifiers. Can also be used for dehumidifying on one relay and temperature control on the other.

Display and diodes:

2 row display where two parameters can be monitored. Green “Normal” diode and red “Alarm” diode, switches at a set value of any of the four parameters.

Analogue outputs:

2 outputs with Vdc or mA, choose source from the PI-regulator or one of the four parameters above.

PI-regulator:

Controls energy-saving on a three phase dehumidifier or a valve for a cooling coil. Set relative humidity, absolute humidity, dew-point or temperature and EH-3 will keep it constant.

Sensor:

Capacitive type moisture sensor from Honeywell with an accuracy of $<\pm 2\%RH$ and $<\pm 0,5^{\circ}C$. Each sensor comes with a calibration protocol.

**ONLY AVAILABLE
FROM DST!**

Sensor

- Measuring range** : -30°C up to +80°C. 0-100%RH (not condensing)
- Accuracy** : $\pm 2\%RH$ and $\pm 0,5^\circ C$ in the full measuring range
 $\pm 1\%RH$ at 50%RH during 5 years
- RH stability** : Each sensor comes with a calibration protocol for 0%RH and 75,3% RH.
- Calibration** : The sensor can easily be changed and after setting the calibration parameters on the display the $\pm 2\%RH$ accuracy is obtained again.
- Response time** : At low air speed, 30 seconds
- Mounting** : 10 m sensor cable and wall mounting device included

Box

- Dimensions** : height: 120 mm, depth 90 mm, width 122mm
- Display** : 2 row LCD
- Visual Alarm** : Green diode marked "Normal" and red diode marked "Alarm"
- Programming** : Four push-buttons for programming.
- Casing** : IP65,ABS.Surrounding temperature: 0-50°C
- Weight** : 0,7 kg.
- Mounting:** : 4 screw holes $\varnothing 4mm$, towards the wall.
 c-c height: 90 mm, c-c width: 110mm
- Option** : Frame for panel mounting

Connections and programming

- 2 separate relays** : Potential free, max 230Vac 16A each. Possible to set parameter source, on value, differential down to off value and time delay.
- 2 analogue outputs** : Choose between 0-10Vdc, 2-10Vdc, 0-20mA or 4-20mA. Also possible to choose parameter source and scale.
- PI-regulator** : Occupies one of the analogue outputs if in use. Independent of the two relays.
- Visual alarm:** Possible to choose parameter source, P-band, I-time and set value.
- Parameters** : Independent of the two relays. Possible to choose parameter source and value when it should switch between green diode and red diode. Relative humidity %RH, absolute humidity g/kg, dew-point °Cdp and temperature °C/K/°F.
- Cable size** : Maximum 1 x 1,5 mm² per terminal.
- Supply** : 230Vac, 50Hz (cable not included)

Sensor $\varnothing 15,5mm$

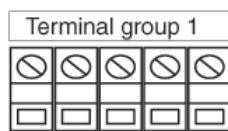

G0 (AGND)
 Analogue output 1
 Analogue output 2

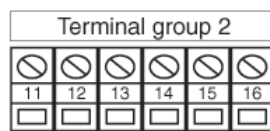

230VAC, Phase
 230VAC, Neutral
 Relay 1
 Relay 2

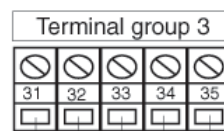

yellow
 white
 brown
 green
 grey
 Temp/RH
 -sensor

Wall mouting device for sensor.

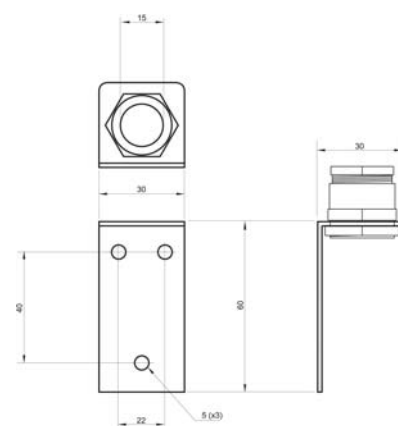

Seibu Giken DST AB

Avestag, 33, S-163 53 Spånga, Sweden
 www.dst-sg.com E-mail: info@dst-sg.com
 tel: +46-8 4457720; fax: +46-8 4457739

Representative: